

**WARNINGS:**

- **TO AVOID PERSONAL INJURY OR DEATH**, keep new and used batteries out of the reach of children. Seek immediate medical attention if a battery is ingested and follow medical advice.
- This product is to be installed and/or used in accordance with electrical codes and regulations.
- If you are unsure about any part of these instructions, consult an electrician.

**CAUTIONS:**

- These devices rely on wireless RF communication.
- Use two CR2025 coin cell batteries **ONLY**. Do not use a rechargeable battery. Use of an improper battery may cause damage to the device.
- For indoor use only.
- These devices are for surface mount or wallbox mount. They are not suitable for retrofit wall box installation where Class 1 wiring is present.

DI-000-ZBK00-00A

**INSTALLATION INSTRUCTIONS****ENGLISH**

| Cat. No.  | Description   |
|-----------|---|
| ZBK00-CSW | GreenConnect Wireless Companion Switch  |
| ZBK00-CDW | GreenConnect Wireless Companion Dimmer  |
| ZBK00-4DW | GreenConnect Wireless Companion Keypad (ON, Raise, Lower, OFF)                |
| ZBK00-4PW | GreenConnect Wireless Companion Keypad with Preset Levels (ON, 50%, 20%, OFF) |

**Product Description**

The GreenConnect™ wireless companion switch (ZBK00-CSW), dimmer (ZBK00-CDW) and 4-button keypads (ZBK00-4DW and ZBK00-4PW) pair with GreenConnect load controllers to provide lighting control where needed. These devices can be mounted in an existing wallbox or to flat wall surface near an entry point. In addition, these devices are battery powered and do not require any wiring to a power source or to the GreenConnect load controllers.

**NOTES:**

- Two replaceable CR2025 batteries with 5-year battery life are included.
- Use to connect to Leviton's GreenConnect load controllers.

**Installation Notes**

- The ZBK00's are battery-powered companion devices that use wireless RF technology for communication to GreenConnect load controllers.
- These devices do not connect directly to the load or lights. Control of the load or lights is through the GreenConnect load controllers, which are line voltage devices (sold separately).
- For best results, mount these devices within 50 ft of a GreenConnect load controller or sensor.
- Do not install these devices in metal wall boxes or with metal wallplates, as this may result in poor RF performance.

**Installation in a Wallbox**

**WARNING: TO AVOID FIRE, SHOCK, OR DEATH**, turn OFF power at the circuit breaker.

To install in a standard NEMA electrical box in single-gang or multi-gang installation:

1. Take note of the TOP marking on the reverse side of the device.
  2. Line up the device with the screw holes in the desired location on the wallbox.
  3. Insert and tighten the screws in the innermost screw holes of the wallbox. Do NOT overtighten the screws.
- NOTE:** Installation in a metal wall box can weaken the RF signal and reduce the wireless range.

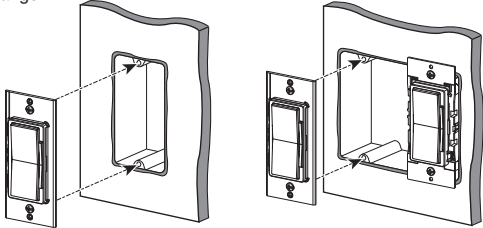
**Installation on a Wall Surface**

1. Select a clear wall surface within 50 ft of the GreenConnect load controller or sensor.
2. Place the included adhesive tape on the reverse side of the device, and align the top and bottom pieces of tape with the corner markings molded into the base.
3. Take note of the TOP and WALL SIDE markings on the back of the device and gently affix the device to the wall surface with the tape. Make sure the device is secure and leveled.

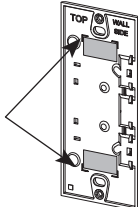

Back View

**NOTE:** Cat. No. ZBK00-CDW shown.

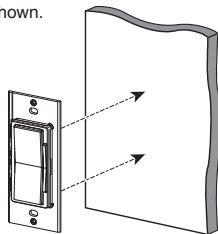

Front View

**Powering ON**

The device comes with two CR2025 batteries (already installed).

1. To power ON the device, place your finger on the indent in the base.
2. Open the device by gently rotating the frame to the left using the hinges.
3. Grasp and pull up each pull tab by its circular portion to remove. Remove both pull tabs (one for each battery).

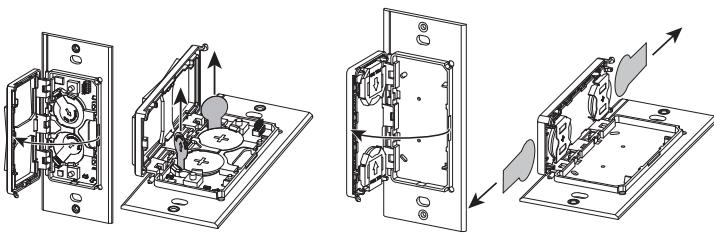

Cat. No. ZBK00-Cxx

Cat. No. ZBK00-4xx

4. Close the device by gently rotating the frame to the right using the hinges.

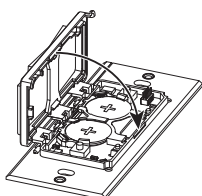

5. Press down firmly in the corners until the device snaps closed.

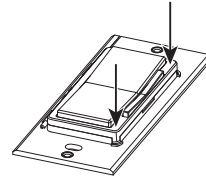
**Specifications**

| Type                      | Specification                               |
|---------------------------|---|
| Operating Temperature     | 32°F - 104°F (0°C - 40°C)                   |
| Operating Humidity        | Relative humidity (non-condensing): 10%-90% |
| Storage Temperature Range | 14°F - 185°F (10° - 85°C)                   |
| Batteries                 | CR2025 x2; 3 V                              |
| Network                   | 2.4 GHz                                     |
| Range                     | 50 ft                                       |
| IP Rating                 | IP20  |

**Pairing**

Follow the steps below to pair the device with a compatible GreenConnect load controller.

**System Programming****1. Required components**

- a. GreenConnect systems require one load controller to create a wireless network and function as the network manager. This can be a wireless power pack or line voltage wall station. Receptacles and battery-powered devices cannot create a network.
- b. A maximum combination of 16 load controllers, wall stations, or sensors can be enrolled into the network.
- c. GreenConnect devices are also compatible with GreenMAX DRC Wireless for systems that require more than 16 devices.

**2. Creating a GreenConnect network**

- a. Ensure no other networks within the building are open before proceeding.
- b. Enter programming mode by pressing and holding the test button on the load controller or the top paddle of the wall station until the LED blinks amber once, then release (approximately seven seconds). The LED will begin blinking amber rapidly.
- c. Tap the test button or top paddle twice to create a new network and designate the device as the network manager. The load will toggle ON and OFF twice and the LED will begin to blink green slowly once the network has been created and is open for enrollment.
- d. Proceed to device enrollment.

**3. Enrolling devices to a GreenConnect network or GreenMAX DRC Wireless network**

- a. Enter programming mode on the device.
- b. Tap the test button or top paddle once to enter enrollment mode. The LED will begin blinking green slowly while searching for a network to join. Upon successful enrollment into a GreenConnect network, the LED will blink green rapidly three times and all enrolled devices will toggle their load ON and OFF twice.
- c. Battery-powered entry stations create a direct connection to the network manager or load controller that opened the network.
- d. To enroll the device into a GreenMAX DRC network, use the GreenMAX DRC App to scan the QR code and follow the instructions included with the GreenMAX DRC room controller.
- e. While the network is open, the LED on all connected devices will blink green slowly. Every 60 seconds the LED of the network manager will pause and blink red once for each device enrolled in the network.
- f. If after 60 seconds the device does not find a network to join, the LED will blink red three times and exit enrollment mode.
- g. To end enrollment and close the network, tap the test button or top paddle once on the network manager. The LED will stop blinking green, blink red three times and all devices will toggle their load ON and OFF.
- h. The network will automatically close if after 10 minutes no new devices have been enrolled.

**4. Adding a device to an existing network**

- a. Enter programming mode on any line voltage device within the network.
- b. Tap the test button or top paddle once to open the network. Battery-powered devices cannot open a network.
- c. Proceed to device enrollment.

**5. Resetting device**

To remove a device from a network, press and hold the test button on the load controller, or sensor, or top paddle of the wall station until the LED blinks amber twice (approximately 12 seconds) then release. The LED will blink red rapidly while the device leaves the network and resets to factory default settings. If the device was a network manager, the network is also deleted.

**6. Sensor settings**

- a. Device settings are saved in the load controller managing the network.
- b. Default settings
  - i. Mode: Auto-ON/Auto-OFF
  - ii. Sensitivity: High
  - iii. Occupancy time-out: 15 minutes
  - iv. Partial Off: Disabled
  - v. Auto-ON level: 50%
  - vi. Photocell: Disabled

## System Programming (continued)

### 7. Adjusting sensor settings

- Enter programming mode on the network manager.
- Tap the test button or top paddle the number of times that corresponds to the menu number you want to access. The LED will pause, blink amber and blink back green the menu number selected, pause, then blink amber the menu option currently saved.
- Once within the menu, tap the test button or top paddle again the number of times that corresponds with the option you want to select. The LED will blink amber according to the option that is selected.
- To return to programming mode, press and hold the test button or top paddle for seven seconds then release. The LED will resume blinking amber once in programming mode.

### 8. Sensor Menus

| Menu #3: Auto-ON level |               |
|------------------------|---------------|
| Setting #              | Value         |
| 1                      | 100%          |
| 2                      | 50% (default) |
| 3                      | 25%           |
| 4                      | Manual-ON     |

| Menu #6: Partial-OFF level |                    |
|----------------------------|--------------------|
| Setting #                  | Value              |
| 1                          | Disabled (Default) |
| 2                          | 50%                |
| 3                          | 25%                |

| Menu #4: Sensitivity |                |
|----------------------|----------------|
| Setting #            | Value          |
| 1                    | Medium         |
| 2                    | Low            |
| 3                    | High (default) |

| Menu #7: Partial-OFF time-out |                      |
|-------------------------------|----------------------|
| Setting #                     | Value                |
| 1                             | 5 minutes            |
| 2                             | 15 minutes (Default) |
| 3                             | 30 minutes           |
| 4                             | 60 minutes           |

| Menu #5: Occupancy time-out |   |
|-----------------------------|---|
| Setting #                   | Value   |
| 1                           | Test mode (30 seconds for five minutes then reverts to prior setting) |
| 2                           | 60 minutes  |
| 3                           | 30 minutes  |
| 4                           | 15 minutes (default)  |
| 5                           | 5 minutes   |
| 6                           | Disabled  |

| Menu #8: Daylighting Target |                    |
|-----------------------------|--------------------|
| Setting #                   | Value              |
| 1                           | Disabled (Default) |
| 2                           | 25 footcandles     |
| 3                           | 35 footcandles     |
| 4                           | 45 footcandles     |

### 9. Device diagnostics

To check device status, press and hold the test button on the load controller, or sensor, or top paddle of the wall station for approximately four seconds then release. Observe LED and see table below.

| LED color | Blink Rate | Status                                      |
|-----------|------------|---|
| Green     | 1 time     | Enrolled, no communication from the network |
| Green     | 2 times    | Enrollment incomplete                       |
| Green     | 3 times    | Enrolled in active network                  |
| Red       | 3 times    | Not enrolled in a network                   |
| Red       | Slow       | Low Battery                                 |

#### FCC STATEMENT

This equipment has been tested and found to comply with the limits for a Class B digital device, pursuant to part 15 of the FCC Rules. These limits are designed to provide reasonable protection against harmful interference in a residential installation. This equipment generates, uses and can radiate radio frequency energy and, if not installed and used in accordance with the instructions, may cause harmful interference to radio communications. However, there is no guarantee that interference will not occur in a particular installation. If this equipment does cause harmful interference to radio or television reception, which can be determined by turning the equipment off and on, the user is encouraged to try to correct the interference by one or more of the following measures:

- Reorient or relocate the receiving antenna.
- Connect the equipment into an outlet on a circuit different from that to which the receiver is connected.
- Increase the separation between the equipment and receiver.
- Consult the dealer or an experienced radio/TV technician for help.

#### IC STATEMENT

This device complies with Industry Canada licence-exempt RSS standard(s). Operation is subject to the following two conditions: (1) this device may not cause interference, and (2) this device must accept any interference, including interference that may cause undesired operation of the device.

**FCC SUPPLIERS DECLARATION OF CONFORMITY (sDoC):** Models ZBK00-CSW (Switch), ZBK00-CDW (Dimmer), ZBK00-4DW (4-Button Keypad / Dimmer), and ZBK00-4PW (4-Button Keypad with Preset Levels) are manufactured by Leviton Manufacturing, Inc., 201 N. Service Road, Melville, NY, www.leviton.com. This device complies with part 15 of the FCC Rules. Operation is subject to the following two conditions: (1) This device may not cause harmful interference, and (2) this device must accept any interference received, including interference that may cause undesired operation. Any changes or modifications not expressly approved by Leviton Manufacturing Co., could void the user's authority to operate the equipment.

**RF EXPOSURE AND CO-LOCATION:** To comply with FCC OET Bulletin 65 and ISSED RF exposure limits for general population and uncontrolled exposure, this device shall be installed and operated with a minimum distance of 7.9 inches (20 cm) between the radiator and your body. Also, must not be co-located or operated in conjunction with any other antenna or transmitter.

Patents covering this product, if any, can be found on [www.leviton.com/patents](http://www.leviton.com/patents).

LEVITON, the Leviton logo, and GreenConnect are trademarks of Leviton Manufacturing Co., Inc.

#### FOR CANADA ONLY

For warranty information and/or product returns, residents of Canada should contact Leviton in writing at **Leviton Manufacturing of Canada ULC** to the attention of the **Quality Assurance Department, 165 Hymus Blvd, Pointe-Claire (Quebec), Canada H9R 1E9 or by telephone at 1-800-405-5320.**

#### LIMITED 5 YEAR WARRANTY

For Leviton's limited 5 year product warranty, go to [www.leviton.com](http://www.leviton.com). For a printed copy of the warranty, call 1-800-824-3005.

## Attach the Wallplate

You can attach any Decora®-style standard or screwless wallplate in single- and multi-gang configurations.

- Insert the screws into the outermost screw holes of the wallplate mounting bracket, and tighten until snug. Do NOT overtighten.
- Snap on the wallplate.

## Changing the Batteries

- Remove the wallplate. (If using a screwless wallplate, you do not have to remove the mounting bracket.)
- Place your finger on the indent in the base, and open the device by gently rotating the frame to the left using the hinges.

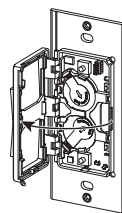

Cat. No. ZBK00-Cxx

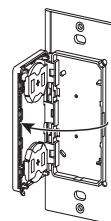

Cat. No. ZBK00-4xx

- Place your finger in the gaps indicated by the arrows, and gently pull the batteries out of the holder. While lifting the batteries, press on battery holder tabs to release batteries.

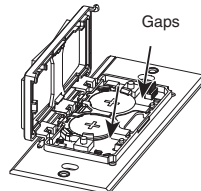

Cat. No. ZBK00-Cxx

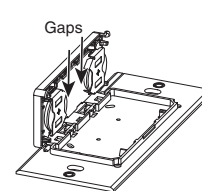

Cat. No. ZBK00-4xx

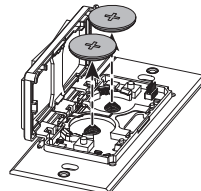

Cat. No. ZBK00-Cxx

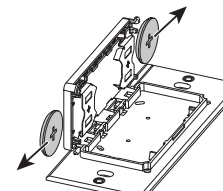

Cat. No. ZBK00-4xx

- In each battery space, insert a CR2025 battery only.
- Close the device by gently rotating the frame to the right using the hinges.

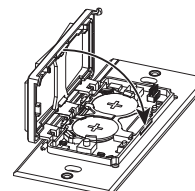

- Press down firmly in the corners until the device snaps closed.
- Re-attach the wallplate.

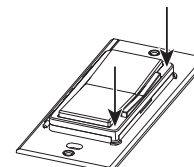

## What to do if...

If the device is not performing as expected, review the troubleshooting information below, or contact Leviton's Technical Support team.

#### The device does not pair to the GreenConnect load controller.

- Make sure you are pairing to a compatible device.
- Ensure the device is within 50 ft of the GreenConnect load controller. In addition, make sure you followed the pairing instructions in System Programming completely.

#### How do I know if I have a compatible GreenConnect load controller?

Go to [leviton.com/greenconnect](http://leviton.com/greenconnect) for additional product details and list of compatible devices.

#### The device has an intermittent connection to the GreenConnect load controller:

- Ensure the device is within 50 ft of the GreenConnect load controller.
- This device does not transmit through exterior surfaces. Environmental factors can impact the wireless signal. Before installing, consider materials, such as concrete or steel reinforced floors, ceilings, walls, masonry, cinder block, and reinforced materials, such as plaster and stucco that may interfere with the wireless signal.
- Check to make sure the device does not have a low battery. (See the Diagnostic LEDs table.)

#### Can one wireless switch or dimmer belong multiple GreenConnect networks?

Yes. Enroll the device in the first network, then repeat with the second network.

#### How do you clean the device?

Use a damp cloth with mild soap. DO NOT use disinfecting products, including foggers, sprays, or other types of atomized cleaning agents.