

Single-Gang Touch Screen



Cat. Nos. TS004-E, TS004-W

Ratings: **Input Voltage/Frequency:** +12-24V DC **Input Current:** 200mA at 12V DC, 120mA at 24V DC

WARNINGS:

- **TO AVOID FIRE, SHOCK OR DEATH: TURN OFF POWER AT CIRCUIT BREAKER OR FUSE AND TEST THAT THE POWER IS OFF BEFORE WIRING!**
- To be installed and/or used in accordance with electrical codes and regulations.
- For indoor applications only.
- If you are not sure about any part of these instructions, consult an electrician.

CAUTIONS:

- No user serviceable components. **DO NOT** attempt to service or repair.
- Use this device **WITH COPPER OR COPPER-CLAD WIRE ONLY.**
- **SAVE THESE INSTRUCTIONS.**

DI-000-TS004-02A-X2

INSTALLATION INSTRUCTIONS

ENGLISH

Product Description

Leviton's 4 in. Single Gang Touch Screen is an integral component as part of a DRC (Distributed Room Control System). It's used to place one or more multi-button keypads with the flexibility of push-button style control, on-the-fly labeling and additional user interface components like sliders, scene control, group control, and bi-directional communication with your lighting control system.

Before Installation

- Requires a standard 1-gang device backbox or low-voltage mounting ring. No faceplate is required. Multi-gang installations with more than one touch screen in a common backbox, are not supported.
- Requires Category 6A or better cabling.
- Maximum run length may be reduced based on wire gauge and total network load. To determine maximum run length and minimum wire gauge:
 - Determine total network current by adding up the device load of each individual connected device on your network.
 - Using the chart below, find the row corresponding to the next highest load from your maximum calculating in the step above, and, the column corresponding to your actual run length to the longest 100 ft.
 - Your maximum supported run length can be found in the Max Run column.
 - The intersection of the row and column indicate the minimum power supply size required to successfully power your network. If your power supply is not large enough, source a larger supply, or contact your Leviton representative to assist with a solution.
 - Cat 6 wire gauge may be 24 AWG if the intersection of your row and column falls within the shaded conditions below, otherwise you must use 23 AWG.

NOTES:

- Leviton supplied patch cables are 24 AWG. If your system requires 23 AWG cabling, then all cables must be 23 AWG. Even a single 24 AWG, reduces the capacity of your system and potentially cause it to malfunction.
- Source voltage for conditions listed below is 24V DC.
- Network runs greater than 1600 ft require repeaters. Contact your design team for details if needed.

Actual Run Length & Minimum Power Supply Sizing

Total Device Load	Max Run	50 ft	100 ft	200 ft	300 ft	400 ft	500 ft	600 ft	700 ft	800 ft	900 ft	1,000 ft	1,100 ft	1,200 ft	1,300 ft	1,400 ft	1,500 ft	1,600 ft
50mA	10,859 ft	60mA	60mA	60mA	60mA	60mA	60mA	60mA	60mA	60mA	60mA	60mA	60mA	60mA	60mA	60mA	60mA	60mA
100mA	5,429 ft	110mA	110mA	110mA	110mA	110mA	110mA	110mA	110mA	110mA	110mA	120mA	120mA	120mA	120mA	120mA	120mA	120mA
150mA	3,619 ft	160mA	160mA	160mA	160mA	160mA	160mA	170mA	170mA	170mA	170mA	180mA	180mA	180mA	180mA	190mA	190mA	200mA
200mA	2,714 ft	210mA	210mA	210mA	220mA	220mA	230mA	230mA	230mA	240mA	240mA	250mA	260mA	260mA	270mA	270mA	280mA	290mA
250mA	2,171 ft	260mA	260mA	270mA	270mA	280mA	290mA	300mA	300mA	310mA	320mA	330mA	340mA	350mA	360mA	370mA	390mA	400mA
300mA	1,809 ft	310mA	310mA	320mA	330mA	340mA	350mA	360mA	380mA	390mA	400mA	420mA	440mA	450mA	470mA	490mA	520mA	540mA
350mA	1,551 ft	360mA	370mA	380mA	390mA	410mA	420mA	440mA	460mA	480mA	500mA	520mA	550mA	580mA	610mA	640mA	680mA	-
400mA	1,357 ft	410mA	420mA	440mA	450mA	470mA	500mA	520mA	540mA	570mA	600mA	640mA	680mA	720mA	770mA	-	-	-
450mA	1,206 ft	460mA	470mA	500mA	520mA	540mA	570mA	600mA	640mA	680mA	720mA	770mA	830mA	900mA	-	-	-	-
500mA	1,085 ft	520mA	530mA	560mA	590mA	620mA	650mA	700mA	740mA	800mA	860mA	930mA	-	-	-	-	-	-
550mA	987 ft	570mA	580mA	620mA	650mA	690mA	740mA	800mA	860mA	930mA	1,020mA	-	-	-	-	-	-	-
600mA	904 ft	620mA	640mA	680mA	720mA	780mA	830mA	900mA	980mA	1,080mA	1,200mA	-	-	-	-	-	-	-
650mA	835 ft	680mA	700mA	740mA	800mA	860mA	930mA	1,020mA	1,120mA	1,250mA	-	-	-	-	-	-	-	-
700mA	775 ft	730mA	750mA	810mA	870mA	950mA	1,040mA	1,150mA	1,280mA	-	-	-	-	-	-	-	-	-
750mA	723 ft	780mA	810mA	880mA	950mA	1,040mA	1,150mA	1,290mA	1,460mA	-	-	-	-	-	-	-	-	-
800mA	678 ft	840mA	870mA	940mA	1,030mA	1,140mA	1,270mA	1,440mA	-	-	-	-	-	-	-	-	-	-
850mA	638 ft	890mA	930mA	1,010mA	1,120mA	1,240mA	1,400mA	-	-	-	-	-	-	-	-	-	-	-
900mA	603 ft	940mA	990mA	1,080mA	1,200mA	1,350mA	-	-	-	-	-	-	-	-	-	-	-	-
950mA	571 ft	1,000mA	1,050mA	1,160mA	1,290mA	1,470mA	-	-	-	-	-	-	-	-	-	-	-	-
1,000mA	542 ft	1,050mA	1,110mA	1,230mA	1,390mA	-	-	-	-	-	-	-	-	-	-	-	-	-
1,050mA	517 ft	1,110mA	1,170mA	1,310mA	1,480mA	-	-	-	-	-	-	-	-	-	-	-	-	-
1,100mA	493 ft	1,160mA	1,230mA	1,380mA	-	-	-	-	-	-	-	-	-	-	-	-	-	-
1,150mA	472 ft	1,220mA	1,290mA	1,460mA	-	-	-	-	-	-	-	-	-	-	-	-	-	-
1,200mA	452 ft	1,280mA	1,350mA	-	-	-	-	-	-	-	-	-	-	-	-	-	-	-
1,250mA	434 ft	1,330mA	1,420mA	-	-	-	-	-	-	-	-	-	-	-	-	-	-	-
1,300mA	417 ft	1,390mA	1,480mA	-	-	-	-	-	-	-	-	-	-	-	-	-	-	-
1,350mA	402 ft	1,440mA	-	-	-	-	-	-	-	-	-	-	-	-	-	-	-	-
1,400mA	387 ft	1,500mA	-	-	-	-	-	-	-	-	-	-	-	-	-	-	-	-
1,450mA	374 ft	-	-	-	-	-	-	-	-	-	-	-	-	-	-	-	-	-
1,500mA	361 ft	-	-	-	-	-	-	-	-	-	-	-	-	-	-	-	-	-

NOTE: Conditions in the above table that are indicated with "-", are not supported.

Installation

1. Disconnect power from LumaCAN™ network.
2. Pull LumaCAN cables through backbox opening or device ring, test cables to ensure they are free from shorts and communication is sound.
3. Locate mounting bracket and affix to backbox or device ring. Ensure mounting bracket is level and flat to the wall and the up arrow points up.

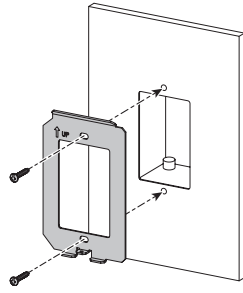

4. If touch screen is in the middle of a LumaCAN run, remove the pre-installed RJ-45 terminator. Otherwise, leave it as is.

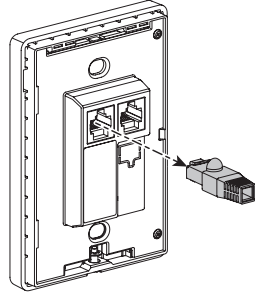

5. Connect LumaCAN cables to the RJ-45 at the rear of the unit.
NOTE: Observe minimum cable bend radius during installation process.

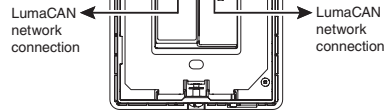

6. Affix touch screen to mounting bracket by holding at a slight angle out from the wall. Slide the touch screen into the top channel, then push down onto the wall. Tighten the security screw through hole at bottom of the touch-screen and into bracket.

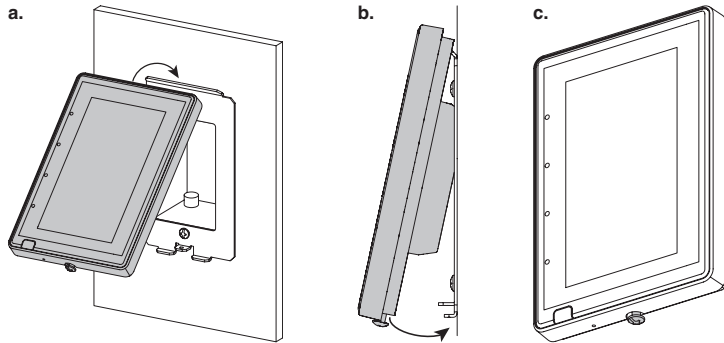

7. Power up the network and proceed to commission the device by a factory certified technician.

FCC STATEMENT

This equipment has been tested and found to comply with the limits for a Class B digital device, pursuant to part 15 of the FCC Rules. These limits are designed to provide reasonable protection against harmful interference in a commercial installation. This equipment generates, uses and can radiate radio frequency energy and, if not installed and used in accordance with the instructions, may cause harmful interference to radio communications. However, there is no guarantee that interference will not occur in a particular installation. If this equipment does cause harmful interference to radio or television reception, which can be determined by turning the equipment off and on, the user is encouraged to try to correct the interference by one or more of the following measures:

- Reorient or relocate the receiving antenna.
- Increase the separation between the equipment and receiver.
- Connect the equipment into an outlet on a circuit different from that to which the receiver is connected.
- Consult the dealer or an experienced radio/TV technician for help.

FCC SUPPLIERS DECLARATION OF CONFORMITY: Models TS004-E and TS004-W are manufactured by Leviton Manufacturing, Inc., 201 N. Service Road, Melville, NY 11747, www.leviton.com. This device complies with part 15 of the FCC Rules. Operation is subject to the following two conditions: (1) This device may not cause harmful interference, and (2) this device must accept any interference received, including interference that may cause undesired operation. Any changes or modifications not expressly approved by Leviton Manufacturing Co., could void the user's authority to operate the equipment.

LIMITED 2 YEAR WARRANTY AND EXCLUSIONS

Leviton warrants to the original consumer purchaser and not for the benefit of anyone else that this product at the time of its sale by Leviton is free of defects in materials and workmanship under normal and proper use for two years from the purchase date. Leviton's only obligation is to correct such defects by repair or replacement, at its option. For details visit www.leviton.com or call 1-800-824-3005. This warranty excludes and there is disclaimed liability for labor for removal of this product or reinstallation. This warranty is void if this product is installed improperly or in an improper environment, overloaded, misused, opened, abused, or altered in any manner, or is not used under normal operating conditions or not in accordance with any labels or instructions. There are no other or implied warranties of any kind, including merchantability and fitness for a particular purpose, but if any implied warranty is required by the applicable jurisdiction, the duration of any such implied warranty, including merchantability and fitness for a particular purpose, is limited to five years. Leviton is not liable for incidental, indirect, special, or consequential damages, including without limitation, damage to, or loss of use of, any equipment, lost sales or profits or delay or failure to perform this warranty obligation. The remedies provided herein are the exclusive remedies under this warranty, whether based on contract, tort or otherwise.

Operation

1. The touch screen will be configured by the My Building/GreenMAX® DRC app, by connecting to your room controller, with a variety of functions as determined by your system configuration. Go to www.leviton.com for a description of configuration options and their uses.
2. Your touch screen has four soft buttons and LED indicators down the left side of the screen which are configurable and should be labeled with their functionality. Swipe from each button out to the right to display a menu of functions that have been configured. Press any button to clear the menu from the screen.
3. Depending on configuration, your touch screen may have one or more "pages" of functions. You can scroll through pages by swiping left or right.
4. Some pages have more information than can fit on a single screen. To scroll through this information, swipe up or down.
5. Your touch screen has a proximity indicator, which dims the screen when no one is nearby, and restores the screen as you get close to it. This is a configurable option.
6. Several indicators display across the top of the screen that indicate the touch screen status.

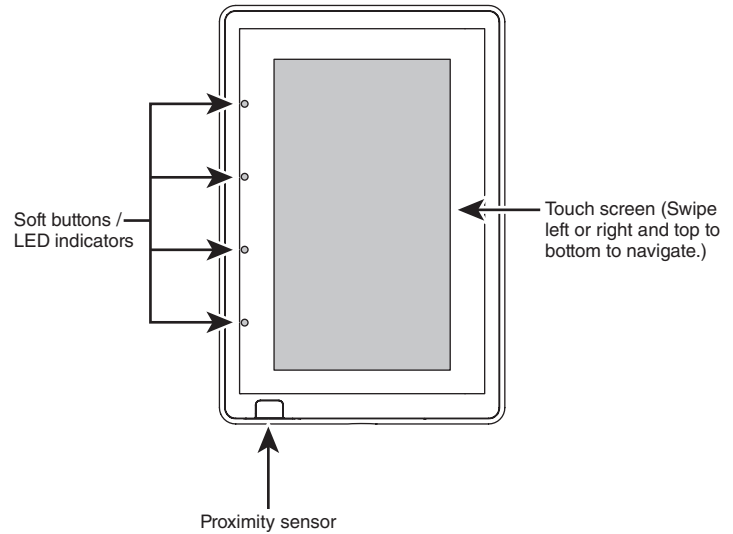

Specifications

Input Voltage/Frequency	+12-24V DC
Input Current	200mA at 12V DC, 120mA at 24V DC
IP Rating	21
Network Connections	<ul style="list-style-type: none"> • LumaCAN via two RJ45 connections • Termination provided via termination plug. <p>NOTE: Feed-through RJ-45 plugs are not supported. Their use will void the product's warranty.</p>
Network Topology	<ul style="list-style-type: none"> • Daisy Chain, 1,600 ft maximum between repeaters. • Home-Run topology and network length up to 10,000 ft can be achieved when using LumaCAN network repeaters (Leviton # NPRPT). • Maximum 110 nodes between repeaters • Maximum 250 nodes on a LumaCAN network.
Operating Temperature	32°F to 104°F (0°C to 40°C)
Storage Temperature	14°F to 140°F (-10°C to 60°C)

IC STATEMENT

This device complies with Industry Canada licence-exempt RSS standard(s). Operation is subject to the following two conditions: (1) this device may not cause interference, and (2) this device must accept any interference, including interference that may cause undesired operation of the device.

RF EXPOSURE AND CO-LOCATION: To comply with FCC OET Bulletin 65 and ICSED RF exposure limits for general population and uncontrolled exposure, this device shall be installed and operated with a minimum distance of 7.9 inches (20 cm) between the radiator and your body. Also, must not be co-located or operated in conjunction with any other antenna or transmitter.

Patents covering this product, if any, can be found on www.leviton.com/patents.

LEVITON and the Leviton logo are trademarks of Leviton Manufacturing Co., Inc.

LumaCAN and GreenMAX are trademarks of Leviton Manufacturing Co., Inc. GreenMAX is registered in the U.S., Canada, Mexico, UAE, Chile, Peru, Venezuela and Costa Rica.

FOR CANADA ONLY

For warranty information and/or product returns, residents of Canada should contact Leviton in writing at **Leviton Manufacturing of Canada ULC** to the attention of the **Quality Assurance Department, 165 Hymus Blvd, Pointe-Claire (Quebec), Canada H9R 1E9** or by telephone at **1-800-405-5320**.