

## Getting Started Guide



**MOTION SENSING DIMMER**  
2<sup>ND</sup> GEN

READ THESE INSTRUCTIONS  
BEFORE INSTALLING



See the complete line of My Leviton™ app compatible dimmers, switches, plug-ins, and controllers at: [leviton.com/decorasmart](http://leviton.com/decorasmart)

Cat. No. D2MSD  
DI-000-D2MSD-02C

### 1

#### FCC COMPLIANCE STATEMENT

The enclosed device complies with Part 15 of the FCC Rules. Operation is subject to the following two conditions: (i.) This device may not cause harmful interference (ii.) This device must accept any interference received, including interference that may cause undesired operation. Any changes or modifications not expressly approved by Leviton could void the user's authority to operate this equipment. This equipment has been tested and found to comply with the limits for a Class B digital device, pursuant to part 15 of the FCC Rules. These limits are designed to provide reasonable protection against harmful interference in a residential installation. This equipment generates uses and can radiate radio frequency energy and, if not installed and used in accordance with the instructions, may cause harmful interference to radio communications. However, there is no guarantee that interference will not occur in a particular installation. If this equipment does cause harmful interference to radio or television reception, which can be determined by turning the equipment off and on, the user is encouraged to try to correct the interference by one or more of the following measures:

- Reorient or retocate the receiving antenna.
- Connect the equipment into an outlet on a circuit different from that to which the receiver is connected.
- Increase the separation between the equipment and receiver.
- Consult the dealer or an experienced radio/TV technician for help.

#### FCC CAUTION

Any changes or modifications not expressly approved by Leviton Manufacturing Co., Inc., could void the user's authority to operate the equipment.

#### FCC SUPPLIER'S DECLARATION OF CONFORMITY

Model D2MSD Wi-Fi Motion Sensing Dimmer is manufactured by Leviton Manufacturing Co., Inc. 201 N. Service Road, Melville, NY 11747. [www.leviton.com](http://www.leviton.com) This device complies with part 15 of the FCC Rules. Operation is subject to the following two conditions: (1) This device may not cause harmful interference, and (2) this device must accept any interference received, including interference that may cause undesired operation.

#### IC STATEMENT

This device complies with Industry Canada license-exempt RSS standard(s). Operation is subject to the following two conditions: (1) this device may not cause interference, and (2) this device must accept any interference, including interference that may cause undesired operation of the device.

#### RF EXPOSURE AND CO-LOCATION

To comply with FCC OET Bulletin 65 and ISED RF exposure limits for general population and uncontrolled exposure, this device shall be installed and operated with a minimum distance of 7.9 inches (20 cm) between the radiator and your body. Also, must not be co-located or operated in conjunction with any other antenna or transmitter.

#### Copyright and Trademark Information

Decora and Decora Smart are the registered trademarks of Leviton Manufacturing Co., Inc., registered in the U.S., Canada, Mexico and China.

Google and Google Play are trademarks of Google LLC. Alexa, and related logos are trademarks of Amazon.com, Inc. or its affiliates. Apple®, HomeKit®, and Siri® are trademarks of Apple Inc., registered in the U.S. and other countries.

Use of the Works with Apple badge means that an accessory has been designed to work specifically with the technology identified in the badge and has been certified by the developer to meet Apple performance standards. Apple is not responsible for the operation of this device or its compliance with safety and regulatory standards.

Use herein of other third party trademarks, service marks, trade names, brand names and/or product names are for informational purposes only, are/may be the trademarks of their respective owners; such use is not meant to imply affiliation, sponsorship, or endorsement. No part of this document may be reproduced, transmitted or transcribed without the express written permission of Leviton Manufacturing Co., Inc.

Patents covering this product, if any, can be found on [leviton.com/patents](http://leviton.com/patents).

Leviton Manufacturing Co., Inc.  
201 North Service Road, Melville, NY 11747

© 2024 Leviton Manufacturing Co., Inc. All rights reserved.  
Specifications subject to change at any time without notice.



## Easy Wi-Fi lighting control for the whole home



### Welcome

Leviton's Decora Smart Wi-Fi 2nd Gen Motion Sensing Dimmer makes it easy and convenient to control lighting in your home automatically, with ON/OFF, Dim/Bright control, and built-in motion and ambient light detection.

To save energy, the dimmer can be set to turn lights on when motion is detected, and to turn lights off when the room is unoccupied. You can also have the lights come on at a lower level at night or utilize the guidelight feature to illuminate your way in the dark. You can even use the Motion Dimmer to control multiple Decora Smart devices in a room together, based on occupancy, with the My Leviton app.



Control lighting how you want with built-in sensing. Use your voice with Amazon Alexa, Google Assistant, or Apple Siri, or use the My Leviton app, even when you are away from home.

### We are here to help

<b>ONLINE</b> decorasmartsupport.leviton.com	<b>CHAT</b> www.leviton.com/support
<b>EMAIL</b> dssupport@leviton.com	<b>CALL</b> 1-800-824-3005 (USA) 1-800-405-5320 (Canada)

1

2



### Features

- Hands-free; automatically turns lights ON/OFF when motion is detected.
- Voice control works with Hey Google, Amazon Alexa, or Apple Siri.
- Easy app-based configuration of motion sensor settings and modes.
- Allows other connected Decora Smart Wi-Fi devices in a room to be activated based on room occupancy.
- Supports 3-Way/Multi-location with Wired Companions and Wireless Anywhere Companions.
- Use the app to enable a Guidelight, that turns ON when motion is detected at night, to illuminate your way in the dark.
- Advanced settings for:
  - Fade rates
  - Pre-set light level or Return to last level
  - Minimum dim / Maximum brightness
  - Bulb types including non-dimmable loads

For more information and features, visit: [leviton.com/decorasmart](http://leviton.com/decorasmart).

5



### Motion Sensing

- The D2MSD's PIR Motion Sensor has a 180° field-of-view, with a maximum sensor coverage area of 900 sq. ft. (30 x 30 ft).
- **Motion Sensor Calibration:** can be used in the My Leviton app to test the Motion Sensor's coverage area, customize the sensor sensitivity, and enable ambient light settings.

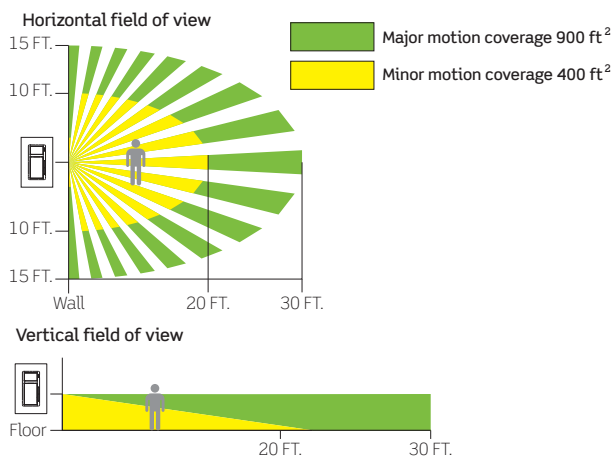

**NOTE:** Device should be installed on the wall, 40-48 inches above the floor.

Sensor modes can be configured under device settings in the My Leviton app:

- **Occupancy Mode:** will automatically turn lights on when motion is detected, and will turn lights off when no motion is detected.
- **Vacancy Mode\*:** requires you to manually turn lights on, but will still turn the lights off when no motion is detected.
- **Guidelight:** can be enabled to turn on at night and softly illuminate a space when motion is detected, instead of turning on the room lights.

\* **Pro Tip: Vacancy mode can be used to comply with 2019 Title 24, Part 6 Vacancy Control Device Requirements.**

6



### Your Motion Dimmer works with:

- Dimmable LED, dimmable CFL, incandescent, and MLV lighting.
- For ON/OFF control of non-dimmable bulbs, such as fluorescent loads, select "Non-dimmable" bulb type in the My Leviton app, under device settings.
- Do not use your dimmer with electronic low-voltage or motor loads.
- Not for use with aluminum wire.
- Installation in metal wall boxes or with metal wall plates may result in poor RF performance.
- This device responds to temperature changes; do not mount directly above a heat source or in a location where hot or cold drafts will blow directly on the sensor.
- For indoor use only.



• For compatible LED bulbs, go to: [leviton.com/LED](http://leviton.com/LED)

RATINGS	
General Use	120VAC, 60Hz
LED / CFL	300W
Incandescent	450W
MLV	450VA
Operating Temperature	0°C - 40°C (32°F - 104°F)
Operating Humidity	10% - 90% non-condensing
Storage Temperature Range	-10°C - 85°C
NETWORK	
Wi-Fi	802.11 b/g/n networks - 2.4GHz only
Security	WPA, WPA2, or WPA3 security, or open
Bluetooth	v5.0
MY LEVITON APP	
iOS	version 12.0 or later
Android	version 8.0 or later

3



### Before you install

Installation requires electrical knowledge. If you are unsure of any steps, consult an electrician.

#### Things to consider:

To control the motion dimmer from more than one location, such as in a 3-way or multi-way, you will need either a wired DD00R or DD0SR Companion device, or a wire-free DAWDC or DAWSC Anywhere Companion device (see page 14).

Learn more about Companion devices and find connection instructions at [leviton.com/decorasmart](http://leviton.com/decorasmart).

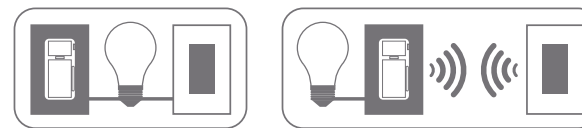

### What you need to make it work:

- A 2.4GHz Wi-Fi network with high-speed internet.
- An iOS (Version 12.0 or later) or Android (Version 8.0 or later) mobile device.  
**NOTE:** Make sure Wi-Fi and Bluetooth are enabled on your mobile device.
- A My Leviton cloud account (set up through the My Leviton app).

7



### At a glance

- **PIR Motion Sensor**
  - Detects motion to determine occupancy status.
  - Optional Red LED feedback to indicate motion is detected (configurable in the My Leviton app).

- **Guidelight**
  - Enable in the app to turn on a guidelight at night instead of the room lights when motion is detected.

- **Air gap switch**
  - This feature will stop power to the dimmer and lights. Gently pull out the tab to remove power to the dimmer and lights. After servicing is complete, push back in for normal operation.

#### Status LED

- Provides connectivity and device status feedback.
- Illuminates when the lights are OFF so you can find the dimmer in the dark (configurable in the My Leviton app).

- **Ambient Light Sensor**
  - Detects amount of ambient light in the space.

- **Dim/bright bar**
  - Manually adjust light levels.

- **Brightness indicator lights**
  - Displays light level when adjusting brightness.

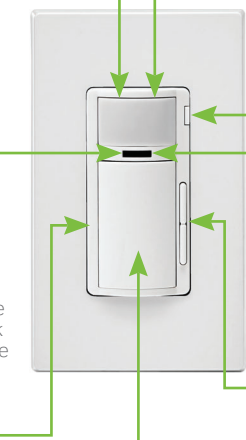

#### ON / OFF Button

- Press to toggle the lights ON or OFF.

#### OFF means OFF

- Ensures low-wattage LED bulbs always turn OFF.

4



### Identify your wires

**WARNING: TO AVOID FIRE, SHOCK, OR DEATH, turn off power at the circuit breaker.**

#### Check your wall box:

1. Remove wallplate and disconnect existing switch.
2. Restore power. Carefully test wires with voltage tester to find the Line (Hot) wire.
3. Turn off power at the circuit breaker.
4. Mark the wires as shown below. Please note Neutral wires are required to operate this device.

**Quick tip:** Neutral wires are typically white and will be found bundled inside the electrical box.



Scan to watch the installation video

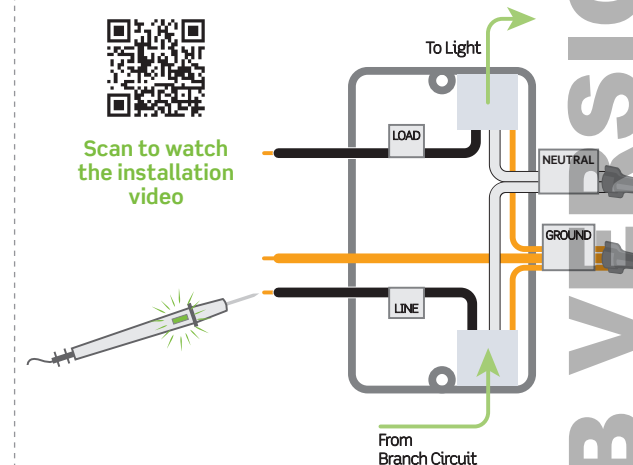

**If your wall box looks different, call an electrician.**

8

WEB VERSION

## Wire your Motion Dimmer

### Single pole installation:

1. Work only one connection at a time.
2. Connect wires as shown, using the included wire connectors.

### NOTES:

- Neutral connection is required.
- The YELLOW/RED Traveler wire is only used in hard-wired 3-way applications. Remember to put a wire connector on the YELLOW/RED Traveler even if not in use.

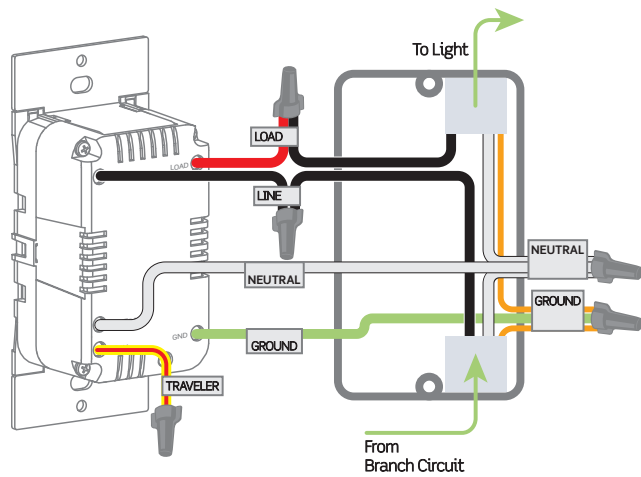

If your wall box contains a different wiring configuration, contact Leviton's Technical Support team or consult an electrician.

9

## Test and install

1. Restore power. Status LED should flash GREEN. This will indicate that your Motion Dimmer is ready to be enrolled.
2. After powering on the Motion Dimmer to confirm it is receiving power, turn the power back off again at the breaker. Do this prior to completing the installation.

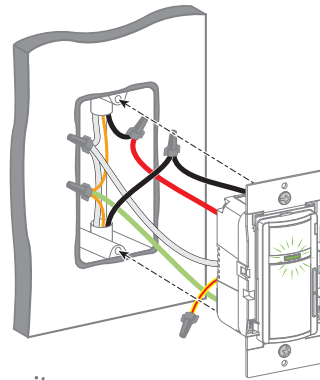

Turn off power at the circuit breaker before screwing in your Motion Dimmer.

3. Gently push wires into wall box. Screw Motion Dimmer to box.

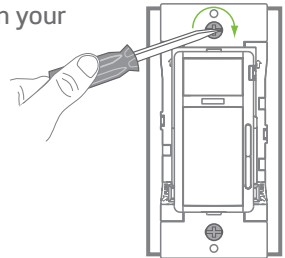

4. Snap on Decora® wallplate and restore power.

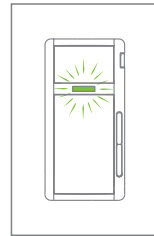

Once power is restored, the status LED will blink GREEN, indicating your device is in Setup mode. See page 16 if your status LED is not blinking GREEN.

**Congratulations!**  
Your Decora Smart Motion Sensing Dimmer is ready to control your lights.

10

## Get the app

To download the app, visit [my.leviton.com](http://my.leviton.com) and select the link, or scan the QR code below for your device.



## Changing Sensor mode

You can use the My Leviton app to adjust all Motion Sensor settings. If you do not have Wi-Fi available, you can switch between Occupancy and Vacancy mode on the device if needed. The Motion Sensing Dimmer is defaulted to Occupancy mode.

**NOTE:** The default Vacancy settings can be used to comply with 2019 Title 24, Part 6 Vacancy Control Device requirements.

1. Press the ON/OFF button 7 times in sequence.
2. The device will change Sensor mode and the Status LED will briefly flash:
  - GREEN, if in Occupancy mode
  - RED, if in Vacancy mode

11

## Device setup

- The Decora Smart Wi-Fi 2<sup>nd</sup> Gen Motion Sensing Dimmer can be connected to the My Leviton service, Apple HomeKit, or both.
- For voice control with Amazon Alexa or Google Assistant, you will need to set up the device with My Leviton.
- For voice control with Siri, you will need to connect your device to Apple HomeKit. See page 15 for instructions on how to add your device to Apple HomeKit.

## Add your device to My Leviton



1. Make sure the device is in Setup mode (status LED should be blinking GREEN). If the status LED is not blinking GREEN, see page 16 for instructions on how to put the device in Setup mode.
2. Launch the My Leviton app.
3. Log in or choose "Sign Up" to create a new account.
4. Follow the instructions on the screen.
5. Once logged in, tap the "+" in the upper right corner and select "Add Device."
6. Follow the app instructions to add your device and to connect it to your home Wi-Fi network.

12

## Test My Leviton app control

1. Open the My Leviton app.
2. Tap icon to turn the Motion Sensing Dimmer ON/OFF.

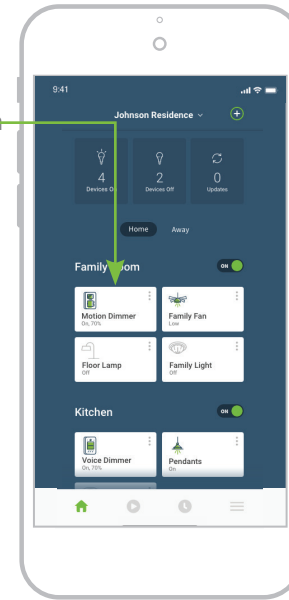

## Quick tips

- The My Leviton app includes many features such as: room occupancy based on motion, room scenes, whole-house activities, remote control, Vacation mode, and advanced options for bulb type, fade rates, preset light level, and minimum dim/maximum brightness.
- Self-service support options can be found in the My Leviton app or at [decorasmartsupport.leviton.com](http://decorasmartsupport.leviton.com).

13

## Connect to My Leviton partners (optional)



Visit [my.leviton.com](http://my.leviton.com) for a complete list of compatible smart home products.

1. Tap menu icon in lower right corner.
2. Tap Integrations, locate the desired service, select it, and follow the instructions.

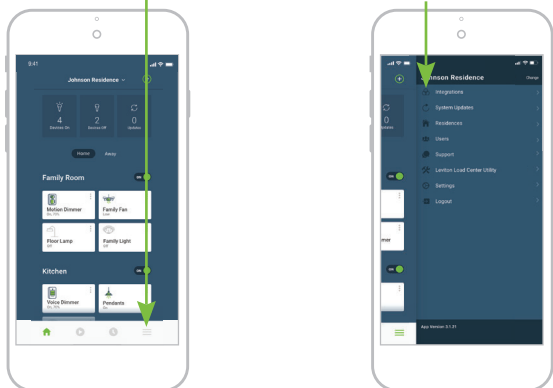

## Pair an Anywhere Companion

1. Place the Anywhere Companion in Pairing mode by pressing the top rocker 5 times. Its Status LED will blink GREEN.
2. Place the primary Decora Smart Wi-Fi Motion Sensing Dimmer into Pairing mode by pressing the ON/OFF button 5 times. The Status LED will flash GREEN/AMBER.
3. The Decora Smart Wi-Fi Motion Sensing Dimmer will automatically pair to the Anywhere Companion in Pairing mode in wireless RF range. Once paired, the Status LED will quickly flash GREEN to show a successful connection.

Learn more about Companion devices and find connection instructions at [leviton.com/decorasmart](http://leviton.com/decorasmart).

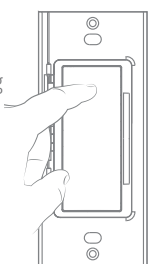

14

## Add your device to Apple HomeKit (optional)



**NOTE:** Skip Step 1 if your device is already enrolled in My Leviton and on your Wi-Fi network.

1. Make sure the device is in Setup mode (status LED should be blinking GREEN). If the status LED is not blinking GREEN, see page 16 for instructions on how to put the device into setup mode.
2. Using an iOS device, open the Apple Home app and select "Add Accessory".
3. Locate and scan the HomeKit setup code on your device or on the front page of this Getting Started Guide.
4. Follow the instructions in the Apple Home app.
5. Once the device is set up, you will be able to voice control your Decora Smart Wi-Fi Motion Sensing Dimmer with Apple Siri.

## Diagnostic LED

If your device is not connecting to the My Leviton app, the Status LED can be used as a diagnostic tool. Press the ON/OFF button for at least 2 seconds (but no more than 7 seconds), and then release. The Status LED will blink a diagnostic code for 2 seconds.

COLOR	STATUS
Amber	Not connected to Wi-Fi.
Red	Connected to Wi-Fi, but unable to connect to the My Leviton cloud.
Green/Amber, Alternating	Connected to Wi-Fi and My Leviton cloud, but unable to set the time from the internet.
Green	Connected to Wi-Fi, and the My Leviton cloud is working properly.

15

## Status LED

COLOR	ACTIVITY	STATUS
Green	Flashing	In Setup mode and ready to be added to a Wi-Fi network.
Green	Slow Blink	Connecting to a Wi-Fi network on power up.
Green or Off	Solid	Normal operation. Can be configured in a setup.
Amber	Slow Blink	Device is not connected to the Wi-Fi network, but is attempting to reconnect.
Green/Amber	Alternating Blink	Device is in wireless Anywhere Companion Pairing mode.
Red	Blink	Wireless Anywhere Companion devices have unpaired or are at max number of paired devices.
Green/Red/Amber	Alternating Blink	Identify feature triggered from the My Leviton app.

## Setup mode

1. Hold the ON/OFF button for 7 seconds until the status light turns AMBER. Then release.
2. The status light will flash GREEN. The device is now in Setup mode.

**NOTE:** To exit, hold ON/OFF button for 7 seconds while in Setup mode.

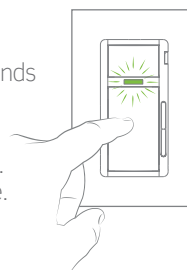

## Factory default reset

1. Hold the ON/OFF button for 14 seconds.
2. After the first 7 seconds, the status light will turn AMBER. Continue to hold.
3. After 7 more seconds, the status light will quickly flash RED/AMBER.
4. Release the ON/OFF button and the device will reset.

16

## What to do if...

**When power is applied, the manual buttons do not control the lights and the lights do not turn ON when motion is present:**

- Verify that the wiring connections are secure.
- For proper operation, the Motion Dimmer needs a Line (Hot), Neutral, Load, and Ground connection.

**When power is applied, the light turns ON, but Motion Dimmer is not able to change the light level:**

- Confirm that the white conductor is a Neutral.
- If using LED or CFL bulbs, make sure they are dimmable.

**Motion Dimmer does not dim low enough, or begins to flicker at the low end of the dimming range:**

- Use the My Leviton app to increase the minimum dim level to the point that it does not cause the LED bulb to flicker.

**Lights do not turn ON when motion is detected:**

- Motion may be beyond sensing range - move closer to device.
- Go to Motion Sensor Calibration in the My Leviton app to increase the sensor sensitivity and coverage area, or adjust the ambient light settings.
- Make sure you are in Occupancy mode.

**Lights always stay ON:**

- Check app settings for how long the Motion Dimmer waits before turning the lights OFF after no motion is detected.
- Check that Dimmer is not installed near a heat source or detecting motion from an adjacent area (e.g., hallway traffic)
- Make sure you are in Occupancy mode.

**Intermittent dimmer operation:**

- Confirm that the Load does not exceed its ratings.

**Not connected to Wi-Fi:**

- If your device is set up in the My Leviton app, select your device, and then select "Device Settings". On the "Device Settings" screen, select "Reconfigure Wireless". Follow prompts to reconfigure device and update Wi-Fi settings.

**How do I clean my device?**

- To clean use a damp cloth with mild soap. DO NOT use disinfecting products, including foggers, sprays or other types of atomized cleaning agents.

Visit [leviton.com/decorasmart](http://leviton.com/decorasmart) or contact Technical Services for additional help.

17

## Safety first

**WARNINGS:**

- **TO AVOID FIRE, SHOCK, OR DEATH, TURN OFF POWER** at circuit breaker or fuse and test that power is off before wiring!
- **TO AVOID FIRE, PERSONAL INJURY, OR PROPERTY DAMAGE, DO NOT** install to control a receptacle, a motor, or transformer operated appliance.
- This product is to be installed and/or used in accordance with electrical codes and regulations.
- For indoor use only.
- If you are unsure about any part of these instructions, consult an electrician.

**CAUTIONS:**

- Use with compatible 120V dimmable LED/CFL bulbs, incandescent, halogen, or magnetic low-voltage (MLV) fixtures. For ON/OFF control of non-dimmable bulbs, such as fluorescent lighting, the non-dimmable bulb type must be selected in the My Leviton app. Use a Leviton electronic low-voltage dimmer to control electronic (solid state) low-voltage transformers. For a list of compatible LED and CFL bulbs, refer to [www.leviton.com](http://www.leviton.com).
- DO NOT mix bulb types when multiple bulbs are used with one dimmer. Using the same make/model of each bulb will enhance dimmer performance.
- The Decora Smart D2MSD dimmer is not compatible with standard 3-way or 4-way switches. It must be used with up to 4 Decora® Smart DD00R-DL or DD0SR companions for wired multi-location dimming.
- Maximum wire length from dimmer to all installed companion devices cannot exceed 300 ft (90m).
- Save this instruction sheet. It contains important technical data, along with testing and troubleshooting information, which will be useful after installation is complete.
- Dimmer may feel warm to the touch during normal operation.
- Recommended minimum wall box depth is 2-3/4 in.
- Use this dimmer with copper or copper-clad wire only.
- Leviton Wi-Fi enabled devices rely on Wi-Fi communication. For customers looking to install a large number of devices, it is recommended to consult the wireless network's access point specifications to determine the maximum number of supported Wi-Fi devices. In some cases, for example large installations, it may be necessary to upgrade to newer high-performance wireless grade access points to ensure proper operation.

**ADDITIONAL RATINGS:**

- Purpose of Control: Operating Control
- Action Control Type: 1
- Pollution Degree: 2
- Impulse Voltage: 2500V
- Disconnection Type: Micro

## Limited 2 Year Warranty & Exclusions

For Leviton's limited product warranty, go to [www.leviton.com](http://www.leviton.com). For a printed copy of the warranty, call 1-800-824-3005.

**FOR CANADA ONLY**

For warranty information and/or product returns, residents of Canada should contact Leviton in writing at Leviton Manufacturing of Canada U.L.C. to the attention of the Quality Assurance Department, 165 Hymus Blvd, Pointe-Claire (Quebec), Canada H9R 1E9, or by telephone at 1-800-405-5320.